

STATE	PROJECT NO.	SHEET NO.	TOTAL SHEETS
N.C.	2025CPT.10.06.20132	1	9
F.A. PROJECT NO.			

ENLARGED MUNICIPAL AND SUBURBAN AREAS  
**CABARRUS COUNTY**  
 NORTH CAROLINA  
PREPARED BY: DHE  
 NORTH CAROLINA DEPARTMENT OF TRANSPORTATION  
 DIVISION OF HIGHWAYS - DIVISION 10 DISTRICT 1

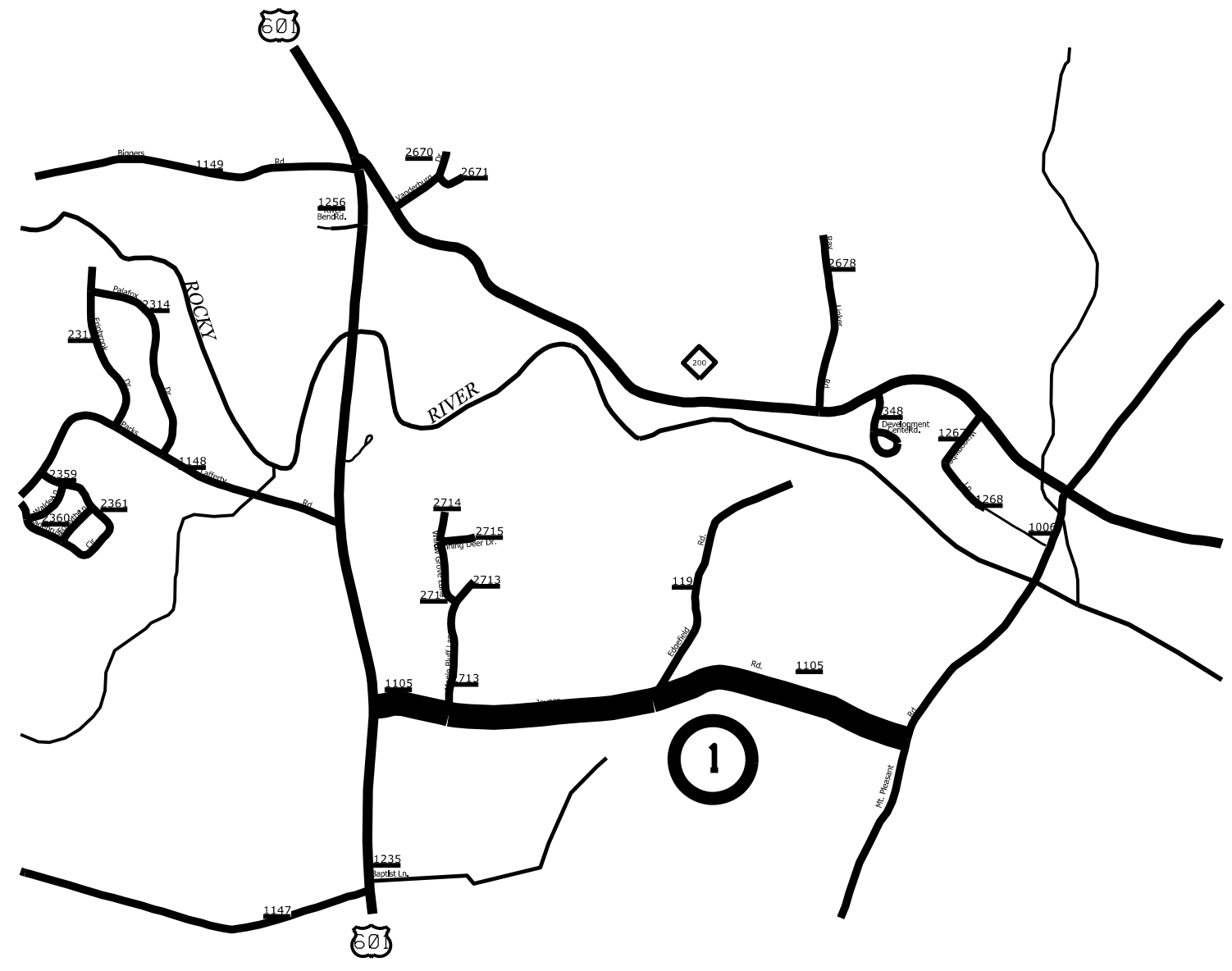

MAP #1 - SR 1105 JOYNER ROAD  
 1.63 MILES  
 FROM SR 1006 MT. PLEASANT RD SOUTH (MP 0.00)  
 TO JOINT BEFORE US 601 (MP 1.63)

STATE	PROJECT NO.	SHEET NO.	TOTAL SHEETS
N.C.	2025CPT.10.06.20132	2	9
F.A. PROJECT NO.			

ENLARGED MUNICIPAL AND SUBURBAN AREAS  
**CABARRUS COUNTY**  
 NORTH CAROLINA

PREPARED BY THE  
 NORTH CAROLINA DEPARTMENT OF TRANSPORTATION  
 DIVISION OF HIGHWAYS - DIVISION 10 DISTRICT 1

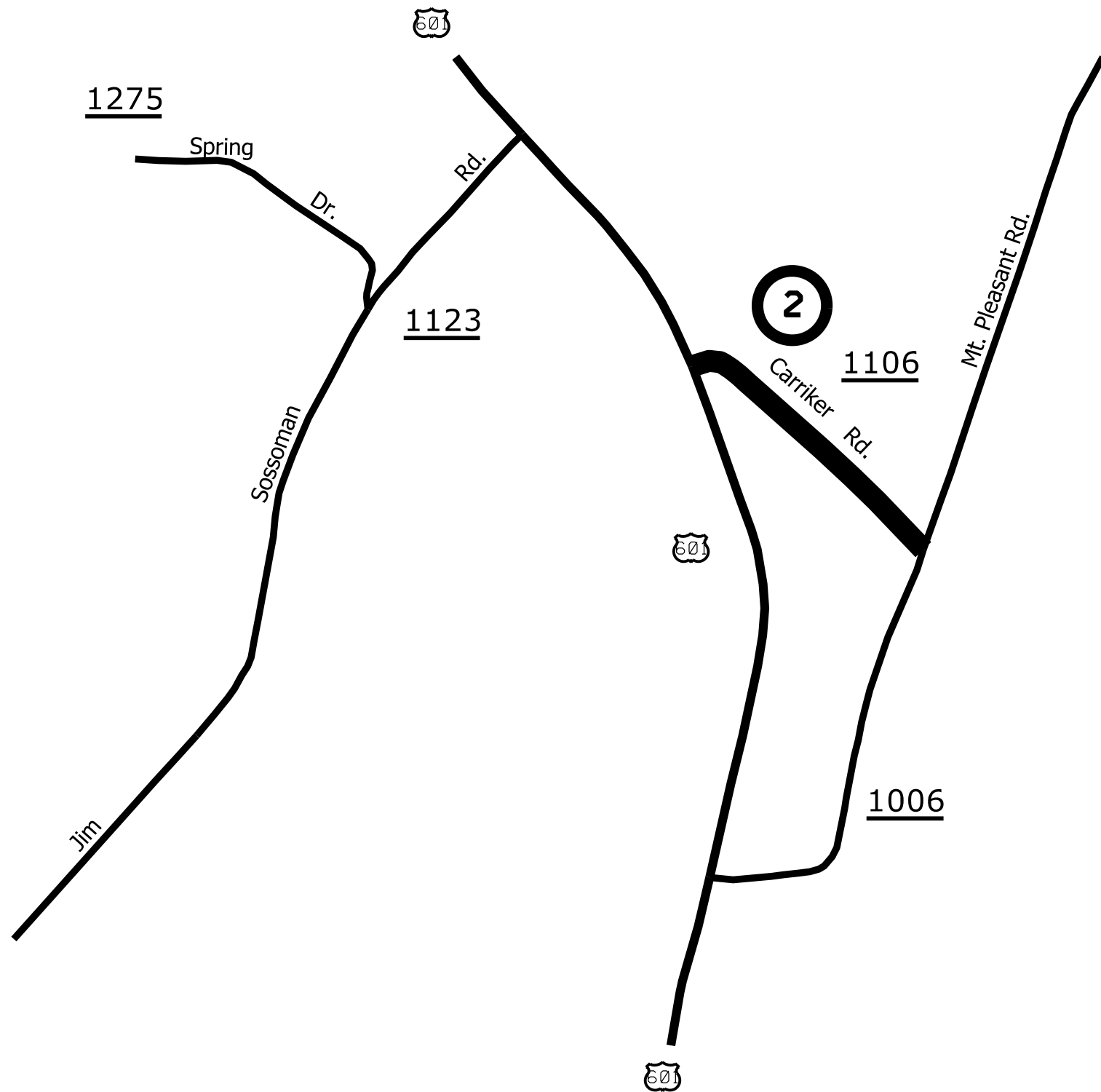

MAP #2 - CARRIKER ROAD  
 0.32 MILES  
 FROM SR 1006 MT. PLEASANT RD SOUTH (MP 0.00)  
 TO JOINT BEFORE US 601 (MP 0.32)

STATE	PROJECT NO.	SHEET NO.	TOTAL SHEETS
N.C.	2025CPT.10.06.20132	3	9
F.A. PROJECT NO.			

ENLARGED MUNICIPAL AND SUBURBAN AREAS  
**CABARRUS COUNTY**  
 NORTH CAROLINA  
PREPARED BY: DHE  
 NORTH CAROLINA DEPARTMENT OF TRANSPORTATION  
 DIVISION OF HIGHWAYS - DIVISION 10 DISTRICT 1

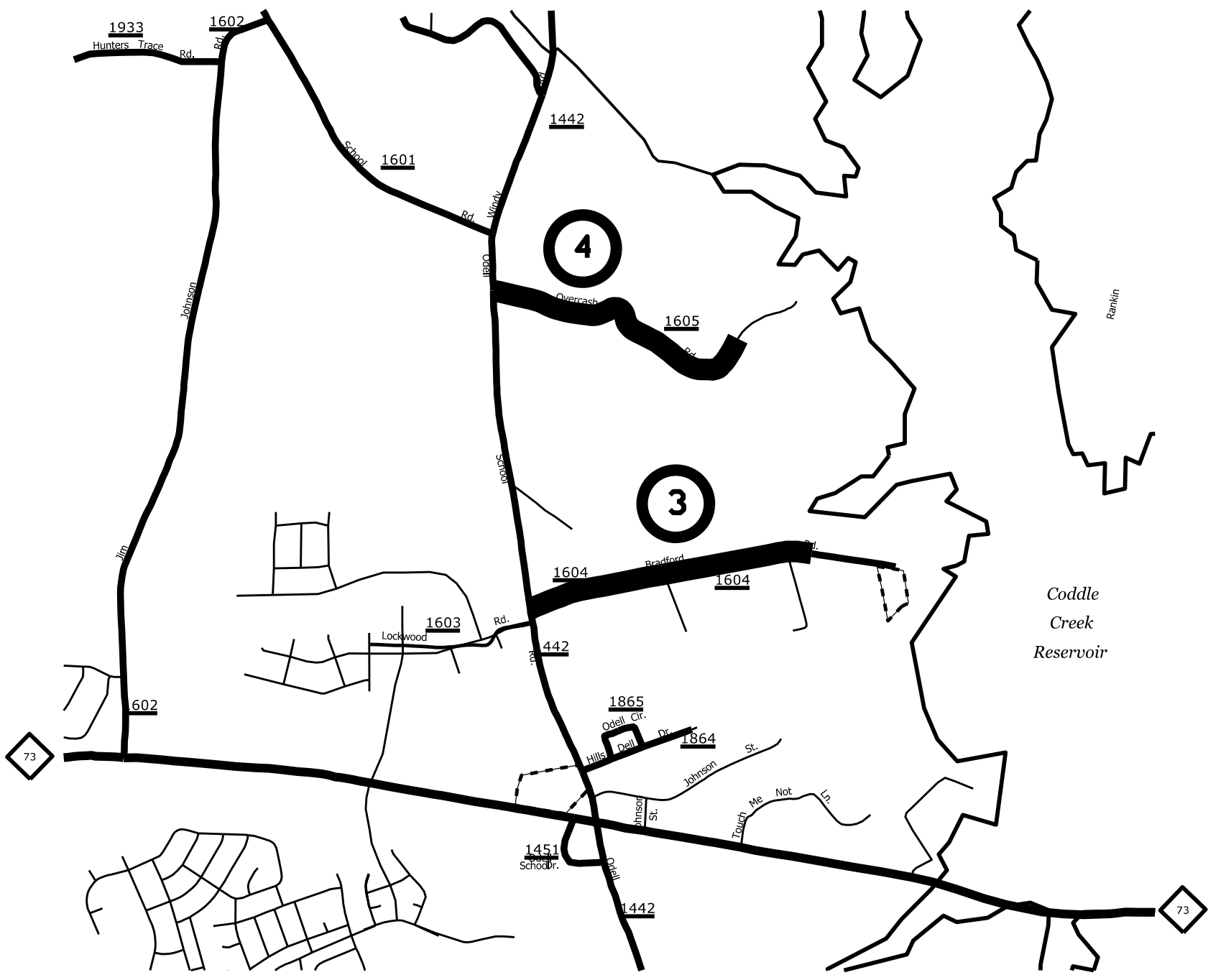

MAP #3 - SR 1604 BRADFORD ROAD  
 0.69 MILES  
 FROM SR 1142 ODELL SCHOOL ROAD (MP 0.00)  
 TO END OF ASPHALT TREATMENT (MP 0.69)

MAP #4 - SR 1605 OVERCASH ROAD  
 0.70 MILES  
 FROM SR 1442 ODELL SCHOOL ROAD (MP 0.00)  
 TO END OF MAINTENANCE (MP 0.70)

STATE	PROJECT NO.	SHEET NO.	TOTAL SHEETS
N.C.	2025CPT.10.06.20132	4	9
F.A. PROJECT NO.			

ENLARGED MUNICIPAL AND SUBURBAN AREAS  
**CABARRUS COUNTY**  
 NORTH CAROLINA

PREPARED BY: DHE  
 NORTH CAROLINA DEPARTMENT OF TRANSPORTATION  
 DIVISION OF HIGHWAYS - DIVISION 10 DISTRICT 1

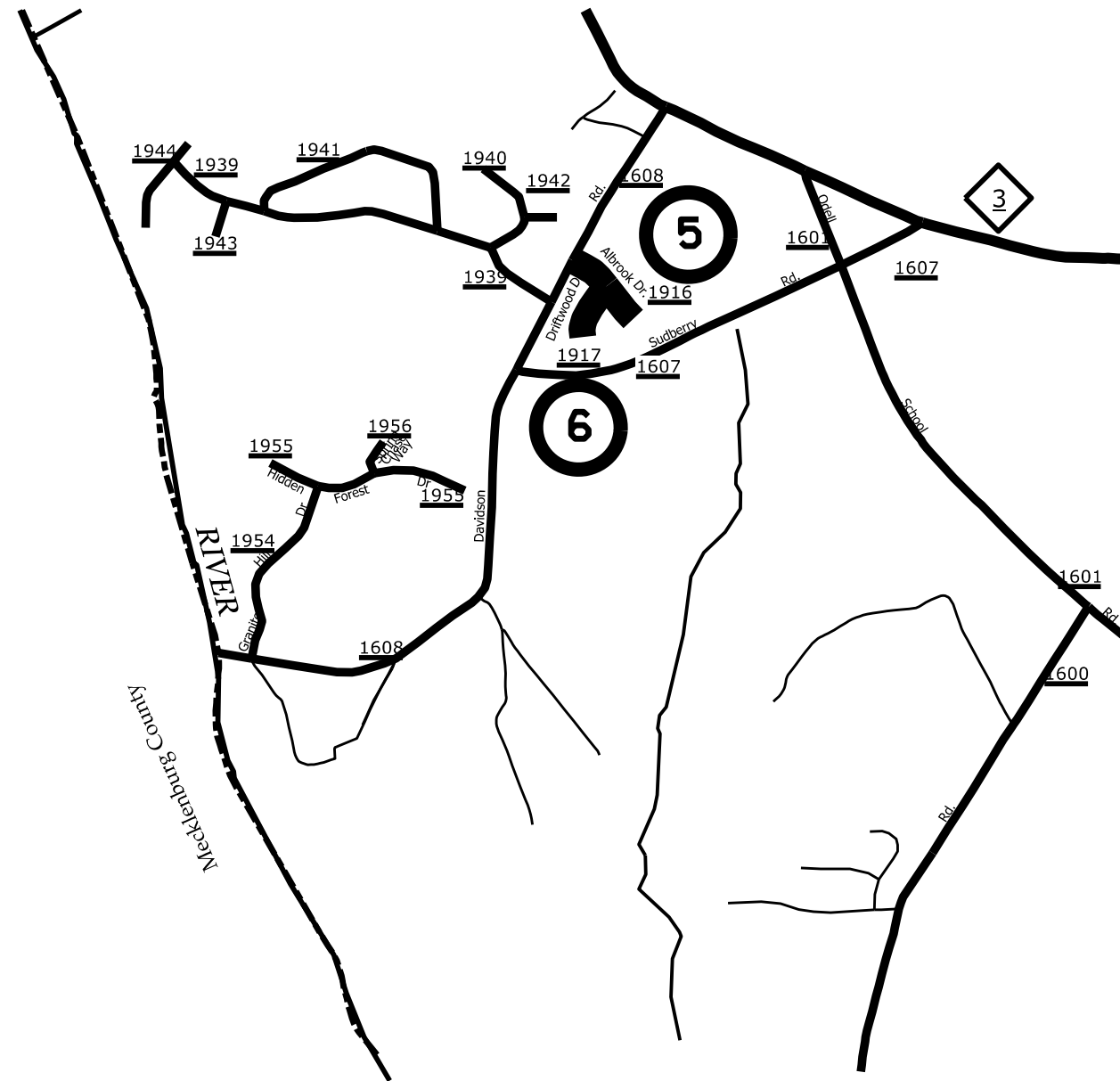

MAP #5 - SR 1916 ALBROOK DRIVE  
 0.16 MILES  
 FROM SR 1608 DAVIDSON ROAD (MP 0.00)  
 TO SR CUL-DE-SAC (MP 0.16)

MAP #6 - SR 1917 DRIFTWOOD DRIVE  
 0.10 MILES  
 FROM SR 1916 SR ALBROOK DRIVE (MP 0.00)  
 TO CUL-DE-SAC (MP 0.10)

STATE	PROJECT NO.	SHEET NO.	TOTAL SHEETS
N.C.	2025CPT.10.06.20132	5	9
F.A. PROJECT NO.			

ENLARGED MUNICIPAL AND SUBURBAN AREAS  
**CABARRUS COUNTY**  
 NORTH CAROLINA

PREPARED BY THE  
 NORTH CAROLINA DEPARTMENT OF TRANSPORTATION  
 DIVISION OF HIGHWAYS - DIVISION 10 DISTRICT 1

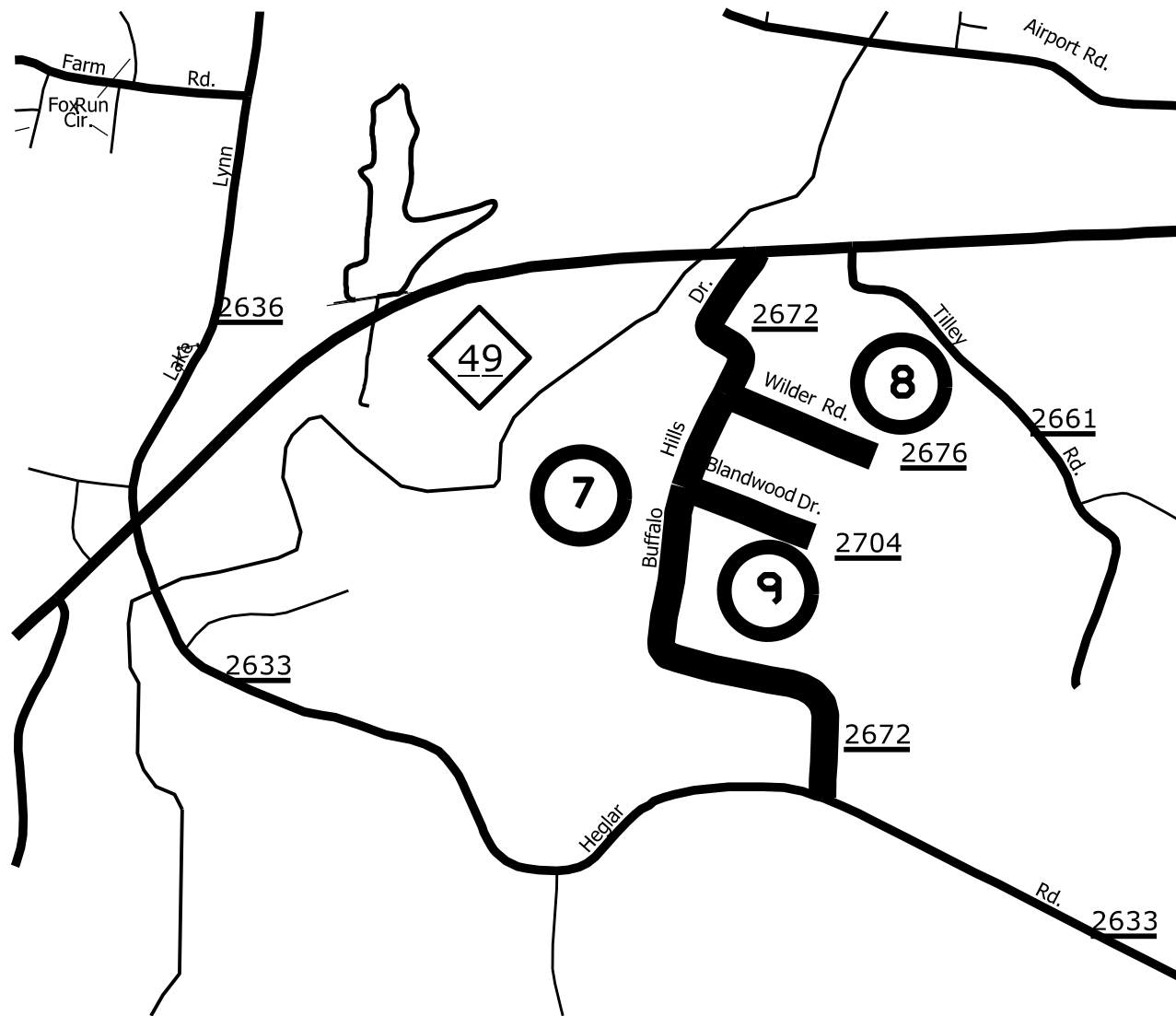

MAP #7 - SR 2672 BUFFALO HILLS DRIVE  
 0.88 MILES  
 FROM JOINT NEAR NC 49 ON SR 2672 BUFFALO HILLS DRIVE (MP 0.01)  
 TO SR 2633 HEGLAR ROAD (MP 0.89)

MAP #8 - SR 2676 WILDER ROAD  
 0.20 MILES  
 SR 2672 (BUFFALO HILLS DRIVE)  
 TO DEAD END (MP 0.20)

MAP #9 - SR 2704 BLANDWOOD DRIVE  
 0.17 MILES  
 SR 2672 (BUFFALO HILLS DRIVE)  
 TO DEAD END (MP 0.17)

# INTERSECTION EMULSION PLACEMENT TWO LANE TWO WAY ROADWAY

STATE	PROJECT NO.	SHEET NO.	TOTAL SHEETS
N.C.	2025CPT.10.06.20132	6	9
F.A. PROJECT NO.			

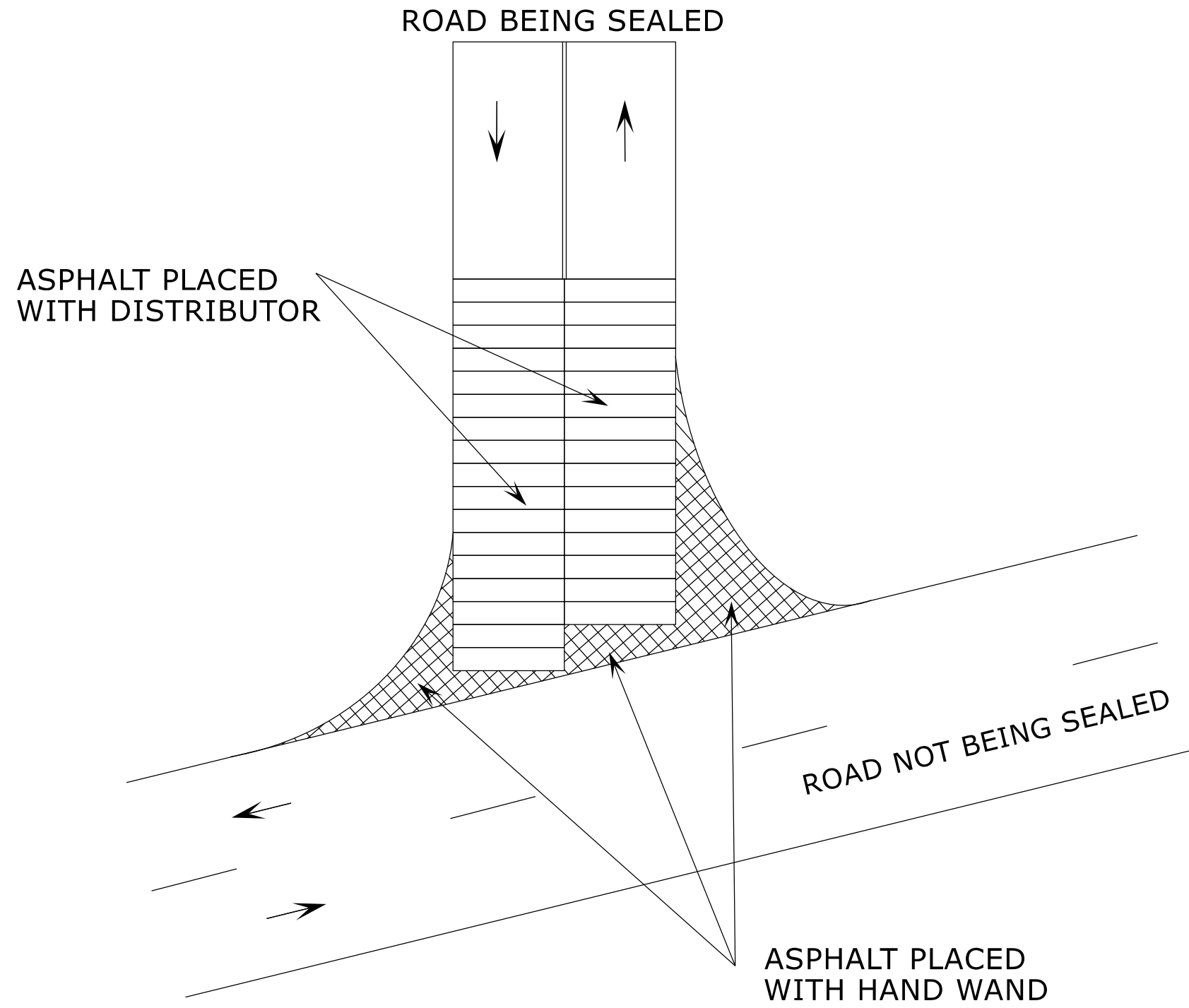

### LEGEND

- DIRECTION OF TRAFFIC FLOW
- SKIP LINES
- ==== DOUBLE YELLOW LINES

# SIGNING FOR ASPHALT SURFACE TREATMENT

STATE	PROJECT NO.	SHEET NO.	TOTAL SHEETS
N.C.	2025CPT.10.06.20132	7	9
F.A. PROJECT NO.			

LEGEND	
	STATIONARY SIGN
	DIRECTION OF TRAFFIC FLOW

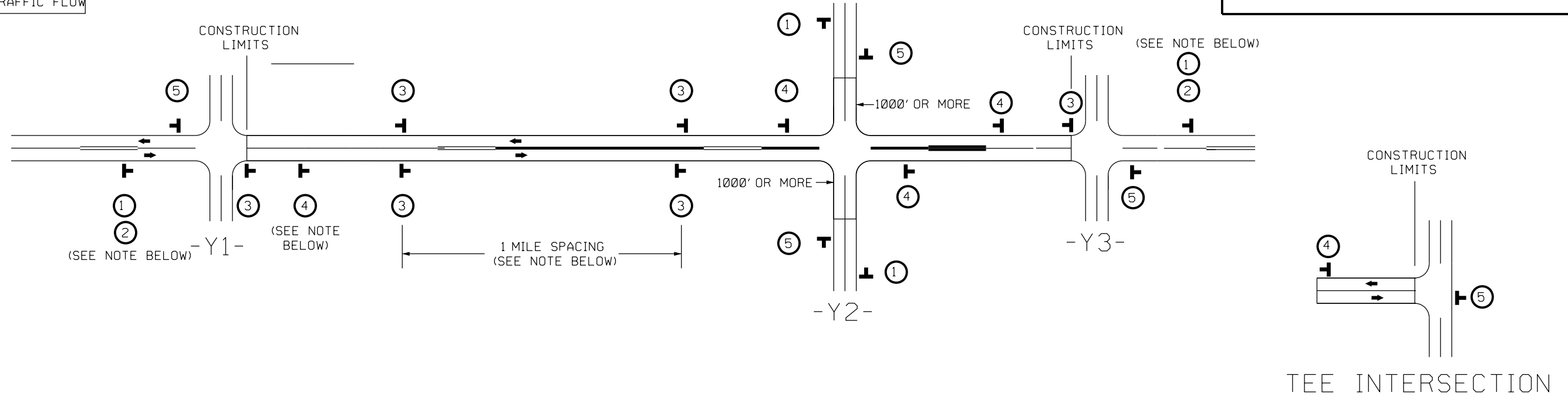

## MAINLINE (-L-) SIGNING

## -Y- LINE SIGNING

SIGNING NOTES AND PLACEMENT PER DIRECTION	<p>1 </p> <p>2 </p> <p>PLACE 1000' PRIOR TO BEGINNING OF CONSTRUCTION LIMITS. ONLY USED ON -Y- LINES IF RESURFACING LIMITS EXTEND 1000' ALONG -Y- LINE.</p> <p>*2 SIGN ONLY USED WHEN CONSTRUCTION LIMITS ARE 2 OR MORE MILES IN LENGTH. (NO FRACTIONAL OR DECIMAL NUMBERS)</p>	<p>NO REQUIRED STATIONARY SIGNING FOR THE FOLLOWING -Y- LINE CONDITIONS:</p> <ol style="list-style-type: none"> <li>1) LESS THAN 1000' OF RESURFACING ALONG -Y- LINE</li> <li>2) SUBDIVISION ROADS</li> <li>3) DEAD END ROADS</li> </ol> <p>WHEN PAVING/CONSTRUCTION ACTIVITIES PROCEED ACROSS AN UNSIGNED -Y- LINE, PORTABLE ADVANCE WARNING SIGNS SHALL BE USED ALONG THE -Y- LINE AS SHOWN BELOW. REMOVE UPON COMPLETION OF WORK.</p> <div style="display: flex; justify-content: space-around;"> <div style="text-align: center;">               W20-1 48" X 48"              PLACED 500' IN ADVANCE OF FLAGGER.         </div> <div style="text-align: center;">               W20-7 A 48" X 48"              PLACED 250' IN ADVANCE OF FLAGGER.         </div> </div>
	<p>3 </p> <p></p> <p>- ALTERNATE THE FOLLOWING TWO SIGNS:</p> <p>- STARTING WITH "LOOSE GRAVEL" (W8-7) FOLLOWED BY "UNMARKED PAVEMENT"</p> <p>- PLACE INITIALLY AT THE CONSTRUCTION LIMITS AND SPACE 1 MILE APART THEREAFTER.</p> <p>- AT TEE INTERSECTIONS INSTALL INITIALLY 1/2 MILE FROM INTERSECTION AND SPACE 1 MILE APART THEREAFTER.</p>	
	<p>4 </p> <p>SP 13106 48" X 48"</p> <p>- THESE ARE FOR -Y- LINES THAT ARE "THROUGH" ROADWAYS.</p> <p>- DEAD END AND SUBDIVISION ROADS ARE NOT "THROUGH" ROADWAYS.</p> <p>- INSTALL 500' +/- FROM EACH -Y- LINE APPROACH AS SHOWN ABOVE.</p> <p>- FOR MULTIPLE -Y- LINES THAT ARE SEPARATED BY 0.25 MILES OR LESS, TREAT AS A SINGLE UNIT AND INSTALL WITHIN 500' OF EACH APPROACH.</p> <p>- A MAXIMUM OF 2 SIGN SETS PER MILE. DO NOT INSTALL WHEN -Y- LINES ARE WITHIN 0.5 MILES FROM "END ROAD WORK" SIGN.</p> <p>- FOR TEE INTERSECTIONS, INSTALL WITHIN 500' +/- OF THE INTERSECTION ALONG -L- LINE.</p>	
	<p>5 </p> <p>G20-2 A 48" X 24"</p> <p>PLACE 500' FOLLOWING THE END OF CONSTRUCTION LIMITS OR AS SHOWN WHEN WORK ENDS AT A 3-WAY TEE INTERSECTION.</p>	

THE ABOVE SIGNS ARE ALL THAT ARE REQUIRED FOR A CONTRACTOR TO BEGIN A RESURFACING CONTRACT. ANY ADDITIONAL SIGNS REQUESTED BY NCDOT DIVISIONS SHALL BE INSTALLED WITHIN 7 BUSINESS DAYS OF THE START OF CONTRACT WORK.

MAPS LESS THAN 2 MILES

FOR AST RESURFACING MAPS WITH CONSTRUCTION LIMITS LESS THAN 2 MILES IN LENGTH, USE A STATIONARY "LOOSE GRAVEL" SIGN AT THE BEGINNING CONSTRUCTION LIMIT FOLLOWED BY AN "UNMARKED PAVEMENT" SIGN MIDWAY THROUGH AND AN "END ROAD WORK" SIGN AT THE END CONSTRUCTION LIMIT.

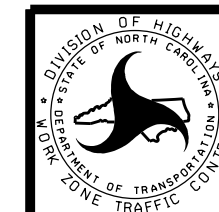

ADVANCE WARNING SIGNS FOR RURAL AND SUBURBAN 2-LANE ROADWAY RESURFACING

PROJECT NO.	SHEET NO.	TOTAL NO.
2025CPT.10.06.20132	8	9

**SUMMARY OF QUANTITIES**

PROJECT NO	COUNTY	MAP NO	ROUTE	DESCRIPTION	TYP NO	LANES	LANE TYPE	LENGTH	WIDTH	BEG N MP	END MP	1803500000-E	1820000000-E	1838000000-E	1838500000-N	2143000000-E
												ASPHALT SURFACE TREATMENT, DOUBLE SEAL	ASPHALT SURFACE TREATMENT, FOG SEAL	EMULSION FOR ASPHALT SURFACE TREATMENT	VACUUM TRUCK	BLOTTING SAND
								MI	FT			SY	SY	GAL	WK	TON
2025CPT.10.06.20132	Cabarrus	1	SR-1105 - JOYNER RD 40001105013	FROM SR 1006 (MT. PLEASANT RD SOUTH) (MP 0.00) TO US 601 (MP 1.63)		2		1.63	20	0	1.63	19,885	19,885	13,325	0.60	0.50
<b>TOTAL FOR MAP NO. 1</b>								<b>1.63</b>				<b>19,885</b>	<b>19,885</b>	<b>13,325</b>	<b>0.60</b>	<b>0.50</b>
2025CPT.10.06.20132	Cabarrus	2	SR-1106 - CARRIKER RD 40001106013	FROM SR 1006 (MT. PLEASANT RD SOUTH) (MP 0.00) TO US 601 (MP 0.32)		2		0.32	20	0	0.32	4,047	4,047	2,715	0.20	0.50
<b>TOTAL FOR MAP NO. 2</b>								<b>0.32</b>				<b>4,047</b>	<b>4,047</b>	<b>2,715</b>	<b>0.20</b>	<b>0.50</b>
2025CPT.10.06.20132	Cabarrus	3	SR-1604 - BRADFORD RD 40001604013	FROM SR 1442 (ODELL SCHOOL ROAD) (MP 0.00) TO END MAINTENANCE (MP 0.70)		2		0.7	18	0	0.7	7,801	7,801	5,230	0.40	0.50
<b>TOTAL FOR MAP NO. 3</b>								<b>0.7</b>				<b>7,801</b>	<b>7,801</b>	<b>5,230</b>	<b>0.40</b>	<b>0.50</b>
2025CPT.10.06.20132	Cabarrus	4	SR-1605 - OVERCASH RD 40001605013	FROM SR 1442 (ODELL SCHOOL ROAD) (MP 0.00) TO END OF MAINTENANCE (MP 0.70)		2		0.7	18	0	0.7	7,768	7,768	5,205	0.40	0.50
<b>TOTAL FOR MAP NO. 4</b>								<b>0.7</b>				<b>7,768</b>	<b>7,768</b>	<b>5,205</b>	<b>0.40</b>	<b>0.50</b>
2025CPT.10.06.20132	Cabarrus	5	SR-1916 - ALBROOK DR 40001916013	FROM SR 1608 (DAVIDSON ROAD) (MP 0.00) TO CUL-DE-SAC (MP 0.16)		2		0.16	20	0	0.16	2,527	2,527	1,695	0.20	0.50
<b>TOTAL FOR MAP NO. 5</b>								<b>0.16</b>				<b>2,527</b>	<b>2,527</b>	<b>1,695</b>	<b>0.20</b>	<b>0.50</b>
2025CPT.10.06.20132	Cabarrus	6	SR-1917 - DRIFTWOOD DR 40001917013	FROM SR 1916 (ALSBROOK DRIVE) (MP 0.00) TO CUL-DE-SAC (MP 0.10)		2		0.1	20	0	0.1	1,787	1,787	1,200	0.20	0.50
<b>TOTAL FOR MAP NO. 6</b>								<b>0.1</b>				<b>1,787</b>	<b>1,787</b>	<b>1,200</b>	<b>0.20</b>	<b>0.50</b>
2025CPT.10.06.20132	Cabarrus	7	SR-2672 - BUFFALO HILLS DR 40002672013	FROM NC 49 (MP 0.00) TO SR 2633 (HEGLAR ROAD) (MP 0.88)		2		0.88	20	0	0.88	9,973	9,973	6,685	0.60	0.50
<b>TOTAL FOR MAP NO. 7</b>								<b>0.88</b>				<b>9,973</b>	<b>9,973</b>	<b>6,685</b>	<b>0.60</b>	<b>0.50</b>
2025CPT.10.06.20132	Cabarrus	8	SR-2676 - WILDER RD 40002676013	FROM SR 2672 (BUFFALO HILLS DRIVE) (MP 0.00) TO DEAD END (MP 0.20)		2		0.2	19	0	0.2	2,432	2,432	1,630	0.20	0.50
<b>TOTAL FOR MAP NO. 8</b>								<b>0.2</b>				<b>2,432</b>	<b>2,432</b>	<b>1,630</b>	<b>0.20</b>	<b>0.50</b>
2025CPT.10.06.20132	Cabarrus	9	SR-2704 - BLANDWOOD DR 40002704013	FROM SR 2672 (BUFFALO HILLS DRIVE) (MP 0.00) TO DEAD END (MP 0.17)		2		0.17	18	0	0.17	2,390	2,390	1,605	0.20	0.50
<b>TOTAL FOR MAP NO. 9</b>								<b>0.17</b>				<b>2,390</b>	<b>2,390</b>	<b>1,605</b>	<b>0.20</b>	<b>0.50</b>
<b>TOTAL FOR PROJ NO. 2025CPT.10.06.20132</b>								<b>4.86</b>				<b>58,610</b>	<b>58,610</b>	<b>39,290</b>	<b>3.00</b>	<b>4.50</b>
<b>GRAND TOTAL</b>								<b>4.86</b>				<b>58,610</b>	<b>58,610</b>	<b>39,290</b>	<b>3.00</b>	<b>4.50</b>



PROJECT NO.	SHEET NO.	TOTAL NO.
2025CPT.10.06.20132	9	9

### THERMOPLASTIC AND PAINT QUANTITIES

PROJECT NO	COUNTY	MAP NO	ROUTE	DESCRIPTION	TYP NO	LANES	LANE TYPE	LENGTH	WIDTH	BEGIN MP	END MP	4413000000-E	4457000000-N
								MI	FT			WORK ZONE ADVANCE/GENERAL WARNING SIGNING	TEMPORARY TRAFFIC CONTROL
												SF	LS
2025CPT.10.06.20132	Cabarrus	1	SR-1105 - JOYNER RD 40001105013	FROM SR 1006 (MT. PLEASANT RD SOUTH) (MP 0.00) TO US 601 (MP 1.63)		2		1.63	20	0	1.63	80.0	0.34
<b>TOTAL FOR MAP NO. 1</b>												<b>80.0</b>	<b>0.34</b>
2025CPT.10.06.20132	Cabarrus	2	SR-1106 - CARRIKER RD 40001106013	FROM SR 1006 (MT. PLEASANT RD SOUTH) (MP 0.00) TO US 601 (MP 0.32)		2		0.32	20	0	0.32	80.0	0.07
<b>TOTAL FOR MAP NO. 2</b>												<b>80.0</b>	<b>0.07</b>
2025CPT.10.06.20132	Cabarrus	3	SR-1604 - BRADFORD RD 40001604013	FROM SR 1442 (ODELL SCHOOL ROAD) (MP 0.00) TO END MAINTENANCE (MP 0.70)		2		0.7	18	0	0.7	80.0	0.14
<b>TOTAL FOR MAP NO. 3</b>												<b>80.0</b>	<b>0.14</b>
2025CPT.10.06.20132	Cabarrus	4	SR-1605 - OVERCASH RD 40001605013	FROM SR 1442 (ODELL SCHOOL ROAD) (MP 0.00) TO END OF MAINTENANCE (MP 0.70)		2		0.7	18	0	0.7	80.0	0.14
<b>TOTAL FOR MAP NO. 4</b>												<b>80.0</b>	<b>0.14</b>
2025CPT.10.06.20132	Cabarrus	5	SR-1916 - ALBROOK DR 40001916013	FROM SR 1608 (DAVIDSON ROAD) (MP 0.00) TO CUL-DE-SAC (MP 0.16)		2		0.16	20	0	0.16	80.0	0.03
<b>TOTAL FOR MAP NO. 5</b>												<b>80.0</b>	<b>0.03</b>
2025CPT.10.06.20132	Cabarrus	6	SR-1917 - DRIFTWOOD DR 40001917013	FROM SR 1916 (ALSBROOK DRIVE) (MP 0.00) TO CUL-DE-SAC (MP 0.10)		2		0.1	20	0	0.1	80.0	0.02
<b>TOTAL FOR MAP NO. 6</b>												<b>80.0</b>	<b>0.02</b>
2025CPT.10.06.20132	Cabarrus	7	SR-2672 - BUFFALO HILLS DR 40002672013	FROM NC 49 (MP 0.00) TO SR 2633 (HEGLAR ROAD) (MP 0.88)		2		0.88	20	0	0.88	80.0	0.18
<b>TOTAL FOR MAP NO. 7</b>												<b>80.0</b>	<b>0.18</b>
2025CPT.10.06.20132	Cabarrus	8	SR-2676 - WILDER RD 40002676013	FROM SR 2672 (BUFFALO HILLS DRIVE) (MP 0.00) TO DEAD END (MP 0.20)		2		0.2	19	0	0.2	80.0	0.04
<b>TOTAL FOR MAP NO. 8</b>												<b>80.0</b>	<b>0.04</b>
2025CPT.10.06.20132	Cabarrus	9	SR-2704 - BLANDWOOD DR 40002704013	FROM SR 2672 (BUFFALO HILLS DRIVE) (MP 0.00) TO DEAD END (MP 0.17)		2		0.17	18	0	0.17	80.0	0.04
<b>TOTAL FOR MAP NO. 9</b>												<b>80.0</b>	<b>0.04</b>
<b>TOTAL FOR PROJ NO. 2025CPT.10.06.20132</b>												<b>4.86</b>	<b>1.000</b>
<b>GRAND TOTAL</b>												<b>4.86</b>	<b>1.000</b>